



## All-Metal Flow Meters for Liquids



measuring  
•  
monitoring  
•  
analysing

- Measuring range:  
Water 0.2 - 2 to 40 - 360 L/min  
Oil 0.2 - 2 to 40 - 360 L/min
- Accuracy:  $\pm 5\%$  f. s.
- $p_{\max}$  350 bar,  $t_{\max}$  105 °C
- Connection: G 1/4... G 1 1/4 female
- Material:  
Brass or stainless steel
- Direct indication
- Relatively insensitive to variations in viscosity
- Calibrated for oil or water

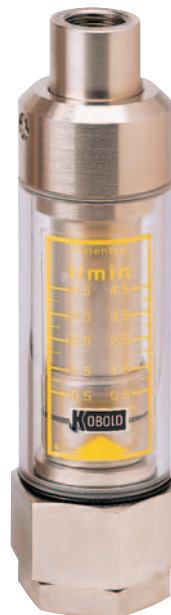

KOBOLD offices exist in the following countries:

ARGENTINA, AUSTRIA, BELGIUM, BRAZIL, CANADA, CHINA,  
FRANCE, GERMANY, GREAT BRITAIN, ITALY, MEXICO, NETHER-  
LANDS, PERU, POLAND, SWITZERLAND, USA, VENEZUELA

KOBOLD Messring GmbH  
Nordring 22-24  
D-65719 Hofheim/Ts.  
☎ +49(0)6192 299-0  
Fax +49(0)6192 23398  
E-Mail: info.de@kobold.com  
Internet: www.kobold.com

**Model:**  
SVC



**Description**

The KOBOLD flow meters of model SVC are remarkable for their simplicity, versatility and ruggedness. The flow rates of oil, water and liquids similar to water can thus be quickly measured. The SVC instruments operate on a very simple principle and are easy to mount. The medium flows through an annular opening created by the cylinder bore and the cone, and produces a pressure difference that forces the piston against a calibrated spring. The stroke of the piston is directly proportional to the flow rate.

Due to the sharp edges of the opening the viscosity has only a negligible effect on the piston stroke. The position of the piston is indicated by means of a magnet fitted in the piston. The magnet moves a steel indicator that slides on the outside of the non-magnetic instrument tube. The display line appears against a colour-coded scale that is printed on the inside of a transparent tube for direct indication of flow rate.

**Technical Details**

- Body of housing: Brass or stainless steel
- Measuring ranges: See Order Details
- Process connection: See Order Details
- Pressure loss: Flow rate and nominal size (upon request)
- Viscosity range: Water (SVC-1...)  
Oil (10 to 200 cSt) (SVC-2...)
- Max. operating pressure: 350 bar
- Max. operating temperature: 90°C (brass version)  
105°C (stainless steel version)
- Accuracy: ±5 % f. s.
- Repeatability: ±1 % f. s.

**Materials**

- Body, connection piece: Brass or st. steel 1.4571
- Piston: Brass or st. steel 1.4571
- Flow taper: Ms version G 1/4: Brass  
Ms version G 1/2: Acetate copolymer  
Ms version G 3/4, G 1 1/4: Acetate homopolymer
- Stainless steel version: Stainless steel 1.4571
- Magnet: Alcomax, PTFE coated
- Taper lock nut: Stainless steel 1.4571
- Seal: FPM
- Spring: oil /Ms version: Steel  
Other versions: Stainless steel
- Indicator: Steel
- Indicator: Polycarbonate, acrylic

**Dimensions (G 1/4, G 1/2, G 3/4)**

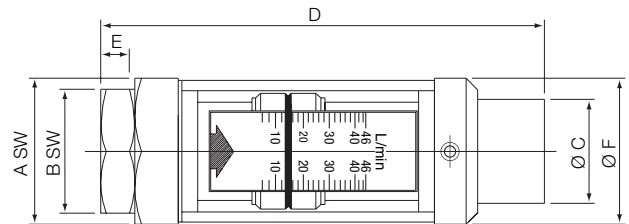

| Thread | A  | B  | C  | D     | E    | F  |
|--------|----|----|----|-------|------|----|
| 1/4    | 32 | 29 | 19 | 123   | 7    | 32 |
| 1/2    | 41 | 38 | 32 | 165.5 | 12.5 | 46 |
| 3/4    | 58 | 46 | 43 | 190   | 15   | 58 |

**Dimensions (G 1 1/4)**

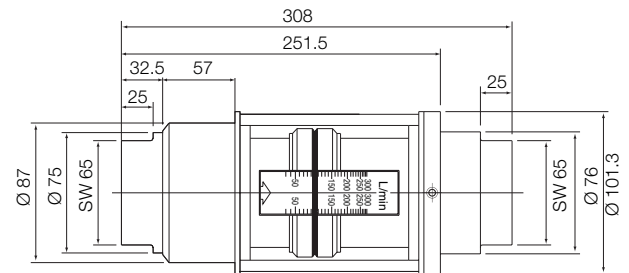

**Order Details**

| Material brass        |                |              |            |
|-----------------------|----------------|--------------|------------|
| Measuring range L/min | Connection     | Medium water | Medium oil |
| 0.2 - 2               | G 1/4 female   | SVC-1101     | SVC-2101   |
| 0.5 - 4.5             | G 1/4 female   | SVC-1102     | SVC-2102   |
| 1 - 9                 | G 1/4 female   | SVC-1103     | SVC-2103   |
| 2 - 20                | G 1/2 female   | SVC-1104     | SVC-2104   |
| 5 - 46                | G 3/4 female   | SVC-1105     | SVC-2105   |
| 5 - 55                | G 1/2 female   | SVC-1106     | SVC-2106   |
| 10 - 110              | G 3/4 female   | SVC-1107     | SVC-2107   |
| 20 - 180              | G 1 1/4 female | SVC-1108     | SVC-2108   |
| 30 - 270              | G 1 1/4 female | SVC-1109     | SVC-2109   |
| 40 - 360              | G 1 1/4 female | SVC-1110     | SVC-2110   |

| Material stainless steel |              |              |            |           |
|--------------------------|--------------|--------------|------------|-----------|
| Measuring range L/min    | Connection   | Medium water | Medium oil | Weight kg |
| 0.2 - 2                  | G 1/4 female | SVC-1201     | SVC-2201   | 0.4       |
| 0.5 - 4.5                | G 1/4 female | SVC-1202     | SVC-2202   | 0.4       |
| 1 - 9                    | G 1/4 female | SVC-1203     | SVC-2203   | 0.4       |
| 2 - 20                   | G 1/2 female | SVC-1204     | SVC-2204   | 0.9       |
| 5 - 46                   | G 1/2 female | SVC-1205     | SVC-2205   | 0.9       |
| 5 - 55                   | G 3/4 female | SVC-1206     | SVC-2206   | 1.75      |
| 10 - 110                 | G 3/4 female | SVC-1207     | SVC-2207   | 1.75      |
| 20 - 180                 | G 1 1/4 fem. | SVC-1208     | SVC-2208   | 8.0       |
| 30 - 270                 | G 1 1/4 fem. | SVC-1209     | SVC-2209   | 8.0       |
| 40 - 360                 | G 1 1/4 fem. | SVC-1210     | SVC-2210   | 8.0       |